

# SG-SGX (smooth inside)

Ear clamps with internal protective ring are ideal for PVC and rubber hoses. The bevelled edges and the internal ring protect the hose from damage.

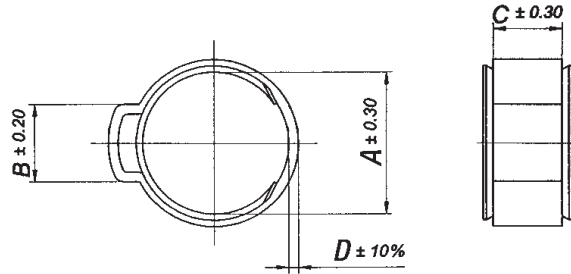

CODE		RANGE Ø	SUPPLIED Ø	BAND THICKNESS	EAR WIDTH	BAND WIDTH
W1*	W4	mm	A mm	D mm	B mm	C mm
SG09,0	SGX09,0	7,5-8,5	8,5	0,8	5,5	6,0
SG10,0	SGX10,0	8,0-9,5	9,5	0,8	6,0	
SG11,0	SGX11,0	9,0-10,5	10,5	0,8	6,5	6,5
SG12,0	SGX12,0	10,0-11,5	11,5	0,8	7,0	
SG12,8	SGX12,8	10,5-12,5	12,5	0,9	7,5	7,0
SG14,0	SGX14,0	11,5-13,5	13,5	1,0	8,0	
ND	SGX15,0	12,4-14,5	14,5	1,0	8,0	
SG16,0	SGX16,0	13,0-15,3	15,3	1,1 (1,0 W4)	8,5	
ND	SGX17,0	14,5-16,3	16,3	1,0	9,0	7,5
SG18,0	SGX18,0	15,0-17,3	17,3	1,2 (1,0 W4)	9,5	
ND	SGX19,0	16,0-18,3	18,3	1,0	9,5	
ND	SGX20,0	17,0-19,3	19,3	1,0	10,0	



## MATERIALS



• RoHS compliant zinc plated steel (\*304 SS internal ring)



• 304 SS



For further details see pag. 75-76



## APPLICATIONS

- Medical industry
- Electronics industry
- Welding equipment
- Beverage industry

